

Tow bar wiring kit with electronic module

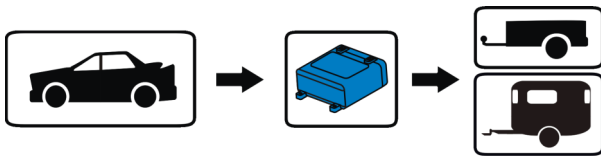







Application:

- Vehicles with 12 V electrical installation;
- Cargo trailers and caravans equipped with electrical installation with 7-pin plug (ISO 1724) or 13-pin plug (ISO 11446) - depending on the wiring kit completion.



Main features:

	G7	G13-8	G13
	Designed for mounting in vehicles with incandescent bulb or LED lamps and with a standard or multiplexed installation		
	Vehicle fog light is not turned off		
	Analog PWM signal analysis		
		✓	✓
			G13-POWER-KIT
			

Short description:

The module does not overload the lamps driving system of the car as the current consumption from signal inputs is approximately 1 mA, which excludes the malfunction of the car electronics systems.

The module is designed to interoperate with both traditional fiber bulbs and LED lamps for cars and trailers. The module uses a digital analysis of multiplexed control for all lights.

The module is a very economical solution designed for mounting both 7-wire and 13-wire installations (depending on the completion).

Assembly kit content:

- Control unit;
- Wiring harness;
- 7-pin or 13-pin trailer socket with seal and screws;
- 10 A fuse with holder;
- Assembly accessories.



Additional accessories:



G13-POWER-KIT — cable set for connecting the power supply to the trailer socket

Complete checking of module correct connection is possible using the tester available in the manufacturer's offer

